

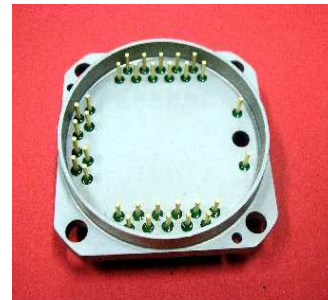

Description

Egide designs and manufactures a full range of hermetic packages for cooled and uncooled Infrared Detector products used in commercial and military thermal imaging and measurement applications. These packages benefit from the company's experience in glass to metal seal, ceramic to metal seal and ceramic HTCC technologies. Egide has integrated assembly capabilities of a variety of components, such as thermal electric coolers, getter assemblies, microconnector assemblies, "pinch off" copper tubes as well as other components.

Our technical design service centers enable a quick turnaround time for any custom design.

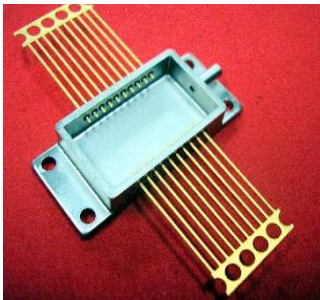

Features

- Hermeticity : 1×10^{-10} cc/s atm He
- Rapid outgassing (high temperature process)
- Integration of other components using brazing and welding technologies (TEC, getters, "pinch off" tubes)
- I/O type : brazed or sealed pins, micro-connector assembly
- GTMS, CTMS or full ceramic packages - HTCC
- Different shapes available (round, rectangular, octagonal)
- Rapid turn around time for custom design
- Cooled or uncooled applications (MCT, a-Si, InSb, .. based)

Contact: sales@egide.fr - sales@egideusa.com
www.egideusa.com - www.egide.fr



Package outline (examples)

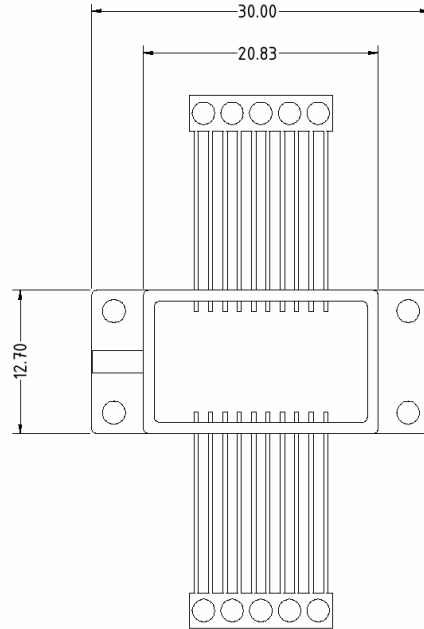
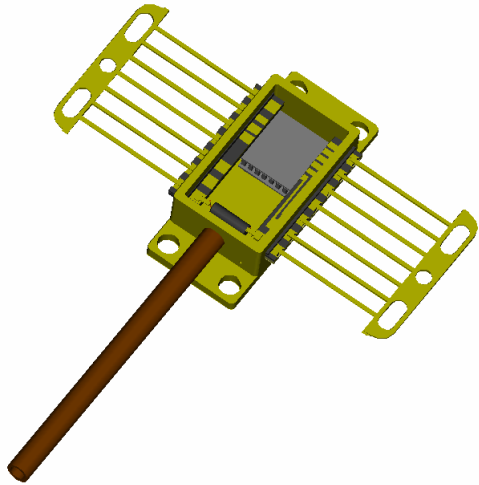

Dimensions in mm

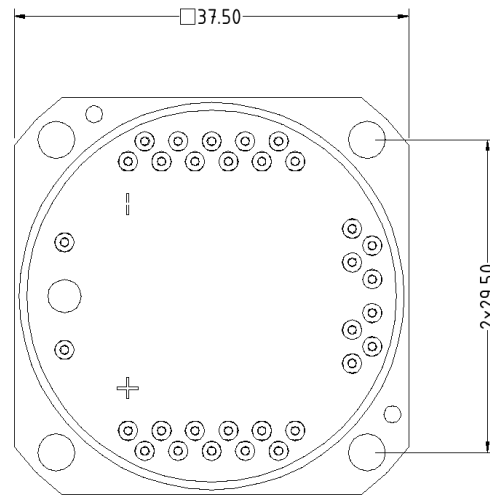
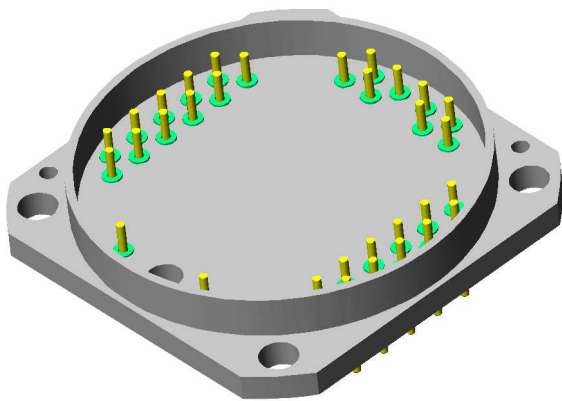

Dimensions in mm

Egide reserves the right to change specifications without prior notice

Contact: sales@egide.fr - sales@egideusa.com
www.egideusa.com - www.egide.fr